

全国免费服务热线  
National Free Service Hotline

**400-113-6788**



Meilun Rotation of the New World  
梅轮转动新世界

# Freight elevator Automobile elevator

载货电梯 / 汽车电梯



 **浙江梅轮电梯股份有限公司**  
ZHEJIANG MEILUN ELEVATOR CO.,LTD.

地址: 浙江省绍兴市柯桥区柯北工业园区齐陶路888号  
Add: No. 888, Qitao Road, Kebei Industrial Park, Shaoxing City,  
Zhejiang Province, China  
电话Tel: (国内home) +86-575-85591811 85662111  
(国外abroad) +86-575-85660116  
传真Fax: (国内home) +86-575-85663000  
(国外abroad) +86-575-85664222  
邮编P.C: 312065  
网址: www.zjml.cc  
E-mail: (国内home): meilun@zjml.cc  
(国外abroad): export@zjml.cc



扫描二维码  
关注梅轮电梯官方网站



扫描二维码  
关注梅轮股份微信公众号

本书为一般信息出版物,我们保留随时更改产品设计和说明的权利,本书的任何字句,无论其字面意思或含义,对于任何产品及产品的用途和质量,或者任何购销合同条款的表述与更改均不承担任何责任。

This publication is for general informational purposes and we reserve the right at any time to alter product design and specification. No statement in it contains should be construed as a warranty or condition, express or implied, as to any production, its fitness for any particular purpose of quality, or any modifications or representation of the term of any purchase agreement.

2023年05月份印刷

浙江梅轮电梯股份有限公司  
ZHEJIANG MEILUN ELEVATOR CO.,LTD.



# Advanced technology

## 产品科技

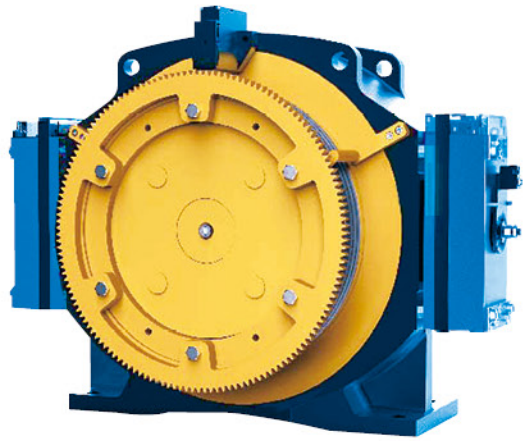

### 永磁同步无齿轮曳引机

Permanent magnetic synchronous gearless traction machine

永磁同步曳引技术是梅轮电梯和曳引机厂家联合开发的符合节能环保理念的新一代电梯核心技术。该技术和传统技术相比，具有低碳节能，更小空间，低建筑成本，和低电梯运行成本的特点；同时轻松实现了曳引机免维护的要求。

Permanent magnet synchronous traction technology is the Meilun elevator traction machine manufacturers and joint development in line with the concept of the next generation of low-carbon energy saving elevator core technology. The technology and traditional techniques, compared with a low-carbon energy, less space, low construction costs, operating costs and low elevator characteristics. Easy to achieve a traction machine maintenance requirements.

### 优良技术，舒适节能

Superior technology; ride comfort and energy efficient

采用VVVF调速技术，大幅减少供电容量，比传统的交流双速技术节能近40%，最大限度地减少电梯功耗，因而成为目前载货电梯调速技术发展方向的前行者。该技术不仅能调节电梯速度，还拥有恒定的力矩特性，不计载荷轻重，能极大地改善电梯运行的舒适感、平层精度、并减小运行噪音。

Adopting VVVF speed regulation technology, it greatly reduces the electrical capacity requirement and can save energy up to 40% as compared with traditional dual speed AC technology. As the forerunner of speed regulating freight elevator, not only it can minimize energy consumption, it has the specialty of constant torque. Despite the load of the elevator, it can provide better ride comfort, leveling capability and with low running noise.



### 有齿轮异步曳引机

Geared asynchronous traction machine

梅轮货梯采用蜗轮副作减速传动装置，有效减小曳引机运行时的噪音，提高平稳性；

传动比大，结构紧凑、传动平稳；

技术成熟，维修效率高，维修成本低；

It applies worm gear traction machine, which can reduce operating noise and with better leveling precision. The compact and asynchronous drive can result in stable running condition too.

This is a mature technology and can make maintenance at ease and with low repair cost.

### 安全装置系统

Safety devices

梅轮轿厢上的安全钳、井道上下端的减速开关、强迫减速开关、极限开关、底坑的缓冲器、机房的减速器等安全部件串联在一起构成安全系统，其中任一环节动作都可使主机断电，轿厢被制动。

Meilun freight elevator is equipped with many safety devices. There are safety gears in the cab, 3 limit switches in the upper and lower end of the hoistway, buffer at the pit and governor in the machine room. Any of these devices triggered will result in power cut off to the machine and cab being stopped.

### 高强度材料，经久耐用

High strength materials and durability

梅轮载货电梯不仅采用高强度型材制作轿厢，还对轿厢底盘进行特殊加强设计，使得自身产品更加经久耐用，不易老化。

The durability of the Meilun freight elevator is made of high strength materials, coupled with a "re-inforced" car bottom design.



### 防撞条（选配）

Anti-collision strip (optional)

防撞条能有效地保护电梯轿厢内壁等不被撞变形或损坏，使电梯工作环境保持良好的状态，明黄色防撞条更具有提示、警示效果。

Anti-collision strip can effectively prevent the car wall getting deformed or damaged during collision. It helps keeping the cab in good condition and has the prompt and warning effect.



### 大宽度开门，大自由进出

Large door width, free entry/exit

为方便大体积货物的自由进出，梅轮载货电梯系列产品均采用多折式轿厢结构，让轿厢门打开可达到最大宽度。

Meilun freight elevator uses multi-panel door to get the widest door opening, which will facilitate the moving in and out of large goods





# Freight elevator

## 载货电梯

梅轮系列载货电梯利用微机控制技术，采用高强度的型材设计制造的轿厢，可在各种恶劣环境下进行货物运输的工作。梅轮载货电梯执行《电梯制造与安装安全规范》等全部现行国家标准。安全可靠、结构强度高、经久耐用、运行平稳、开门距大、性价比高等优点使梅轮货梯成为工厂、仓储、百货商城、物业中心等单位运输货物的理想选择。

Meilun serial freight elevators apply micro-computer control technology. It uses high intensity cars that have been designed and manufactured by section materials. It can transport the freight under various awful conditions. Meilun freight elevator carries out the current national standards such as "The Elevator Manufacture, Installation Safety Standards" etc. Meilun freight elevator is your ideal choice in the factory, warehouse, department store, shopping center, housing property management center etc. because of its safe; durable and reliable properties, high structural strength, smooth operation, large door opening distance, high cost performance and so on.

### 先进控制，安全更节能

The safe and more energy-saving integrated control

梅轮载货电梯控制柜，运用电梯先进控制与驱动完美结合，让电梯运行更加安全高效，更节能环保。而在设计上充分考虑客户的利益诉求，具有极高的性价比。

Control cabinet of Meilun freight elevator applies the integrated idea of integrative elevator control and drive control. It brings about the more secure, effective, energy-saving and environmental-protection elevator running. In the design sector, it gives the customers' interest request into full consideration. It has extremely high cost performance.

### 专业的轿厢

The professional cars

加倍坚固的轿底能可靠承受各类货物，高精度的称重开关严格控制载重以防止超载发生意外；地面采用防滑花纹钢板，即使被油渍污染也能产生足够的摩擦力防止人员滑倒或货物滑动。

Car bottom with doubled reinforcement can bear various freight. High precision weighing switch strictly controls the load to prevent from any overload accidents. The ground applies anti-skid checkered steel plate. Even it is stained by grease, it will still produce enough strong friction to prevent the passengers or the freight to slide off.

### 多种开门方式

The multiple door opening modes

为了满足用户的不同进出要求，梅轮载货电梯有旁开双折门、中分双折门、中分三折门、单通门、以及贯通门等多种开门方式供选择，与工厂、仓储、百货商场、物业中心等建筑物结构灵活匹配。

In order to satisfy different entry/exit requirements from vast users, Meilun freight elevator offers four door opening modes of side opening, center opening double-folded door, one-way door opening, opposite door opening. It can flexibly match with the factory, warehouse, department store, shopping center, housing property management center etc.

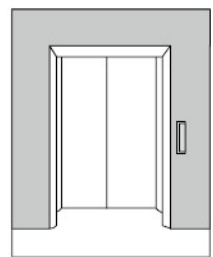

旁开双折门  
Two Panel sliding door

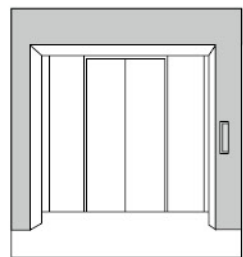

中分双折门  
Center-opening&double-folded

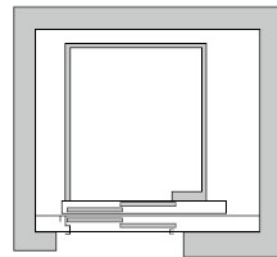

单通门  
Single way door

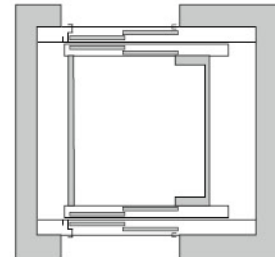

贯通门  
Double way door





# Machine roomless freight elevator

## 无机房载货电梯



梅轮无机房载货电梯，深谙节能降耗理念，不仅节约建筑面积，且提高设计自由度，充分体现绿色低碳。与同等载重量级别的有机房载货电梯相比，节约建筑面积 10%。

Meilun machine roomless freight elevator knows very well of the energy-saving and loss-reducing ideas. It not only saves the building area, but also increases design freedom extent. It gives full play of green low-carbon. Compared with same load level freight elevator with machine room, it saves 10% of the building area.

### 轻松融入建筑

Easily merges with vast constructions

梅轮无机房载货电梯只需井道，无需机房，能为建筑设计带来更多的自由。

Meilun machine roomless freight elevator only needs a well without machine room. It brings about more design freedom to vast buildings.

### 新一代变频调压调速技术

New generation variable frequency voltage regulation and speed governor technology

节能、环保、免维护、舒适感好、低噪音、体积小

It is of the remarkable energy-saving, environmental protection, comfortable travel, maintenance-free, low noise and small bulk.

### 待机休眠技术

Standby & technology

在电梯待机时自动切断电梯内的照明及通风设备。

When the elevator is in stand-by mode, it automatically cuts off the lighting and ventilator fan in the elevator.



### 安装简易高效

Easy and effective installation

在电梯应用中，安装难易也是影响货运条件的重要因素。梅轮无机房载货电梯能为客户提供高效易行的安装方案，保证建筑工程的正常进度。

Easy installation is vital for freight transport in the elevator application. Meilun machine roomless freight elevator provides the customers with easy and effective installation plans. It ensures normal progress of the construction projects.

### 应用场合广泛

Extensive application occasions

与传统有机房载货电梯相比，梅轮无机房载货电梯应用场合广泛，更适用于现代社会的垂直交通领域。

Compared with the traditional freight elevator with machine room, Meilun machine roomless freight elevator has the more extensive application occasions. It better suits the vertical transport field in modern societies.



# Car decoration and design

## 轿厢装饰和设计

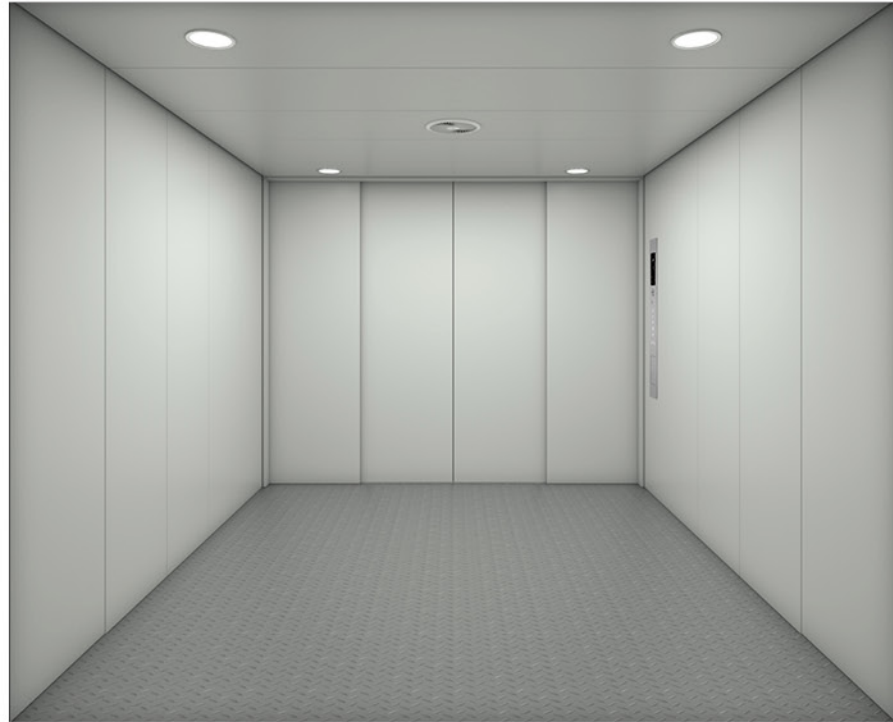

### ML-H-03

吊顶: 喷涂钢板 (颜色可选)  
轿壁: 喷涂钢板 (颜色可选)  
轿门: 喷涂钢板 (颜色可选)  
照明: 节能筒灯  
地板: 花纹钢板

Ceiling: Painted steel (Color optional)  
Cabin: Painted steel (Color optional)  
Car door: Painted steel (Color optional)  
Lighting: Energy-saving down light  
Floor: Checkered steel floor



轿厢 360° 全景展示

### 喷涂色标

Painted color



P-01 (浅灰) Light gray  
标配 Standard



P-04 (苹果绿) Dark green  
选配 Optionl



P-05 (米黄) Beige  
选配 Optionl



P-06 (电脑灰) Gray  
选配 Optionl

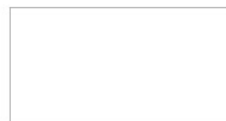

P-07 (白色) White  
选配 Optionl

## 操纵盘、外呼

COP& LOP

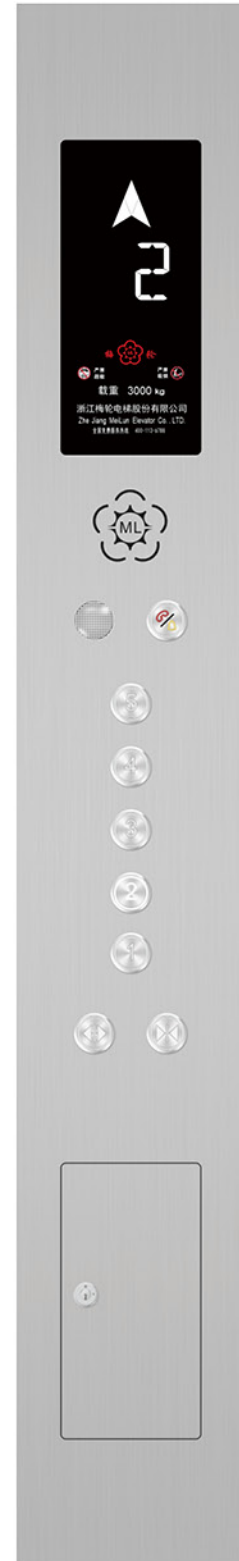

COP118H-C

标配  
Standard



HB527

无底盒 (标配)  
Without bottom case (standard)



COP217H-E-A

选配  
Optional



HB217H-E

有底盒 (选配)  
Bottomed case (optional)

## 厅门系列

Landing door series



旁开双折式  
Side opening

标准配置 (载重 ≤ 3000kg)  
门套: 涂装钢板 (颜色可选)  
层门: 喷涂钢板

Standard (Load ≤ 3000kg)  
Jamb: Painted steel (optional color)  
Landing door: Painted steel



中分双折式  
Center-opening & double-folded type

标准配置 (载重 > 3000kg)  
门套: 涂装钢板 (颜色可选)  
层门: 喷涂钢板

Standard (Load > 3000kg)  
Jamb: Painted steel (optional color)  
Landing door: Painted steel



旁开三折式  
Side opening & three folded type

可选配置  
门套: 涂装钢板 (颜色可选)  
层门: 喷涂钢板

Optional  
Jamb: Painted steel (optional color)  
Landing door: Painted steel



中分三折式  
Center-opening & three folded type

可选配置  
门套: 发纹不锈钢  
层门: 发纹不锈钢

Optional  
Jamb: Hairline stainless steel  
Landing door: Hairline stainless steel

图片系电脑绘制, 可能与实际图有不同。  
The pictures are plotted by computer and are likely somewhat different from the actual products.

图片系电脑绘制, 可能与实际图有不同。  
The pictures are plotted by computer and are likely somewhat different from the actual products.



## Standard function

## 标准功能

电梯变频驱动 VVVF drive	精确调整电动机转速，令电梯启动、运行、停止时的速度曲线平稳、圆滑、获得良好的舒适感。 Motor rotating speed can be precisely adjusted to get smooth speed curve in elevator start, travel and stop and gain the sound comfort.
门机变频驱动 VVVF door operator	精确调整电动机转速、使门机的开启，关闭更轻柔灵敏。 Motor rotating speed can be precisely adjusted to get the more gentle and sensitive door machine start/stop.
独立运行 Independent running	根据用户需要可设置电梯不响应外召，仅响应轿内指令。 According to the users' needs, the elevator can not respond to outer calling, it only responds to inner command in the car.
自动不停站通过 Automatic pass without stop	当轿内挤满乘客或负载接近预定值，为保持最大运行效率，该轿厢将自动越过召唤层站。 When the car is crowded with the passengers or the load is close to preset value, the car will automatically pass the calling landing in order to keep maximum travel efficiency.
开门时间调整 Adjust door opening time	根据用户需要可设置开门时间。 Door opening time is according to the users' demands.
本层重开门 Reopen with hall call	关门途中，可以按本层站召唤按钮使门重新开启。 During door close, pressing the hall call button can reopen the door.
即时关门 Express door closing	电梯停站开门到位时，按下关门按钮，门立即被关闭。 When the elevator stops and opens the door, press door-shut button, the door will be closed immediately.
停梯开门 Car stops and door open	电梯减速平层，直到完全停稳后才开门。 The elevator decelerates and levels, the door only opens after the elevator comes to a complete stop.
轿厢到站钟 Car arrival gong	装于轿顶的电子钟，告知候梯的乘客电梯已到达。 The arrival gong at the car top announces the car's arrival.
防捣乱 Anti- nuisance	电梯轻载时出现超过三个指令时，为避免不必要停靠，轿厢内已登记的召唤将全部自动取消。 When more than three commands appear under light load, all the registered call in the car will be cancelled automatically in order to avoid the unnecessary leveling.
自动返基站 Automatic return to home	在低交通量时，无召唤信号的电梯将自动返回基站，关门等待。 In low traffic flow, the car which has no call will return to the main floor, shut the door and keep waiting automatically.
指令登记删除 Command register cancel	如按错了轿内楼层指令按钮，只要把同一按钮再按一次，就可取消已登记指令。 If floor command button in the car is pressed by mistake, press same button again to cancel the registered command.
提前开门功能 Door pre-open function	电梯减速运行至开门区域内，且运行速度小于设定值时，未到平层位置时，电梯提前开门，以提高运行效率。 When the elevator reduce speed running to door open area and running speed is smaller than setting, before reach leveling position, door will pre-open to prove working efficient.
开门再平层功能 Re-leveling after door open function	电梯停靠在层站，由于载重变化，会造成平层波动，地坎不平，给人员和货物进出带来不便，这时系统允许在开着门的状态下以再平层速度运行到平层位置。 When the elevator stop and each floor, the sill and cabin will not on same flat level because of loading difference, that brings inconvenience. System will level it during door open time.
光幕保护 Photocell protection	门开启和关闭期间，用覆盖整个门高度的红外光幕探测乘客和物体的门保护装置。 In the door open and shut period, the door protection device of infrared ray that covers the whole door height is used to protect both the passengers and objects.
指定停靠 Designated stop	由于某种原因，电梯在目的层无法开门，电梯将关门运行至下一指定层楼。 If the elevator cannot open the door in the destination floor, the elevator will close the door and travel to the next designated floor.
超载停梯 Overload holding stop	在门区轿厢超载时，鸣响蜂鸣器并停止于该层站，保持开门状态。 When the car is overload, the buzzer would ring and the car would remain open at the floor.
防止失速保护 Anti-stall protection	由于曳引钢丝绳打滑而无法正常运行时，电梯停止运行。 The elevator stops operation due to traction rope slip.
启动保护控制 Start protection control	电梯启动后在指定的时间内，没有离开门区，电梯停止运行。 If the elevator does not leave door zone within designated time after it gets started, it will stop running.
检修操作 Inspection operation	当进入检修状态时，轿厢以低速点动运行。 When the elevator enters into inspection operation, the car travels at inching running.
故障自诊断记录 Fault self-diagnosis record	控制器的记录功能，以便快速排除故障，迅速恢复电梯运行。 With the help of this record function, faults can be restored rapidly so that the elevator can remove in a shot time.
地坎杂物清除 Sill impurity removal	因地坎杂物阻碍或干扰，电梯门未能关闭，电梯门在规定时间内会重复打开关闭，把杂物清除。 If the elevator door can not shut due to sill impurity or interference, it reopens/re-shuts in the stipulated time and remove the impurity.
上下极限保护装置 Up/down over-run and final limit protection	该装置可有效防止当电梯万一发生失控时的冲顶或蹲底现象，使电梯更安全可靠。 The device can effectively prevent from the elevator's surging to the top or knocking the bottom when it is out of control. It results in more safe and reliable elevator travel.
下行超速保护装置 Down over-speed protection	当电梯下降运行的速度超过额定速度的1.2倍时，该装置自动切断控制电源，使电机停止运转以阻止电梯超速下行；如电梯继续超速下行，其速度超过额定速度的1.4倍时，安全钳动作，强制电梯停止运行，保证安全。 When the elevator running down speed is 1.2 times faster than the rated speed, this device will automatically cut off control power to stop elevator's over-speed running; If the elevator still over-speed running and the speed is 1.4 times faster than rated speed, safety gear action to force the elevator stop running to keep safe.
自动找平层 Automatically leveling	当电梯处于快车状态下，且未停在开门区域时，只要满足运行条件，电梯将自动慢速运行至开门区域，并自动开门。 When the elevator under normal running and not at door open area, the elevator will slowly running down to the door open area and open the door automatically.

运行功能  
Travel function安全功能  
Safety function

## Standard function

## 标准功能

防溜车保护 Anti-sliding protection	电梯在所设定的时间内连续运行，无任何并道开关动作，控制器视为钢丝绳打滑故障，电梯立即停止。 The elevator running during setting time and no any hoist way switch action, controller will judge as steel rope slipping and stop the elevator immediately.
逆向运行保护 Anti-reverse protection	当系统检测到电梯持续一定时间实际运行方向与指令方向不一致时，将立即停止，报故障。 When the lift controller find the running direction is different from the setting direction, the elevator will stop and given the error code.
抱闸开关保护 Brake switch protection	电梯在运行或者停止状态下，检测到抱闸开关吸合状态异常时，系统自动保护。 When the elevator is under running or stop, find the brake switch is abnormal, system will be self protect.
控制电压过电压保护 Control voltage overload protect	控制电压过电压时，报出故障，停止运行。 When the control voltage is overload, the elevator stop and given the error code.
电机过载识别 Motor overload protection	电机过载时，系统停止运行并输出故障。 When the motor is overload, system stop and given error code.
PG保护 PG protect	带PG矢量控制（或带PG V/F控制），编码器信号断线，系统停止运行并输出故障。 With PG vector control (Or with PG V/F control), encoder signal stop, system stop and given error code.
速度偏差过大识别 Big speed difference Identification	DEV偏差过大时，系统停止运行并输出故障。 When DEV difference is too big, system stop and given error code.
运行超时 Over time running	当运行时间超过理论时间时，系统停止运行并输出故障。 When the running time is more than theory time, system stop and given error code.
限位开关保护 Limit switch protection	电梯不在端站(上、下强换都没有断开)时，限位开关断开，系统停止运行并输出故障。 When elevator is not at end stop(up/down change switch is not break), limit switch break, system stop and given error code.
主输出接触器保护 Main output contactor protection	电梯在运行或者停止状态下，主输出接触器吸合状态异常时，系统自动保护。 When elevator under running or stop, main output contactor close condition abnormal, system self protected.
运行过电流保护 Running over current protection	一体机运行过电流时，系统报出故障，停止运行。 When control panel running over current, system given error and stop running.
输入侧缺相保护 Input open phase protection	输入R.S.T有缺相，系统停止运行并输出故障。 Input R.S.T have open phase, system stop and given error code.
接触器异常识别 Contactor abnormal recognize	接触器出现异常时，系统停止运行并输出故障。 When contactor is abnormal, system stop and given error code.
平层开关保护 Landing switch protection	控制器记录平层开关状态与理论值不符，系统停止运行并输出故障。 Controller record leveling condition is not same as theory data, system stop and given error code.
安全回路保护 Safety circuit protection	安全回路断开，系统停止运行并输出故障。 When the safety circuit brake, system stop and given error code.
抱闸输出接触器保护 Brake output contactor protection	电梯在运行或者停止状态下，抱闸输出接触器吸合状态异常时，系统自动保护。 When elevator under running or stop condition, brake output contactor close condition abnormal, system stop and given error code.
运行过电压保护 Running over voltage protection	运行时输出电压过大时，系统停止运行并输出故障。 When output voltage is too big, system stop and given error code.
输出侧缺相保护 Output open phase protection	输出缺相，系统停止运行并输出故障。 Output open phase, system stop and given error code.
并道开关位置监测保护 Hoist way switch position protection	并道开关位置异常时，电梯报出故障，提供保护。 When hoist way switch position abnormal, system given error code and protect.
强换开关保护 Exchange switch protection	当强换开关有效时，如果速度大于理论速度，则输出故障，以较大的减速度，快速停车。 When exchange switch is workable, if speed is bigger than theory speed, than output fault and stop the elevator in short time.
门锁防粘连 Door lock protection	当电梯开门时，开门状态出现异常，给出故障，停止运行。 When the elevator open and close the door, the open/close condition is abnormal, system stop and given error code.
内召按钮防卡死 COP button stuck protection	系统可以识别出厅内召唤按钮的卡死情况，自动去除该卡死的召唤，避免电梯由于内召按钮的卡死情况而无法关门运行。 System can find out the button stuck condition, cancel the stuck call to avoid the elevator stop running because of door opening.
外召按钮防卡死 LOP button stuck protection	系统可以识别出厅外召唤按钮的卡死情况，自动去除该卡死的召唤，避免电梯由于外召按钮的卡死情况而无法关门运行。 System can find out the button stuck condition, cancel the stuck call to avoid the elevator stop running because of door opening.
门区范围外禁止开门 Door open forbid out of door open area	为确保安全，在门区外，系统禁止开门。 To make sure the safety, the door will not open out of door area.
轿厢意外移动保护装置 UCMP	提高运行安全满足新规标准，防止开门走车风险。 To make sure the safety and according to new standard, avoid door opening running risk.

安全功能  
Safety function





# Standard function

## 标准功能

 人机界面 Man-machine interface	轿内及层站微动指令按钮 Micro-touch button for car call and hall call	轿内操纵箱指令按钮及层站召唤按钮采用新型微动型按钮。 Novel micro-touch button is used for operation panel command button in the car and landing calling button.
	轿内层楼、方向指示 Floor and direction indicator	轿内显示电梯所在层楼及当前运行方向。 The car shows the elevator floor location and current travel direction.
	层站层楼、方向指示 Floor and direction indicator in hall	层站显示电梯所在层楼及当前运行方向。 The landing shows the elevator floor location and current travel direction.
	应急照明 Emergency car lighting	停电时，自动打开轿内应急照明。 Emergency car lighting automatically activated once power failure.
 应急功能 Emergency function	开门时间延长 Door opentime extending	按轿厢内的专用按钮，可使门在一段时间内保持开门状态。 Press special button in the car, the elevator door keeps open for certain period of time.
	点动运行 Inching running	当进入紧急电动状态时，轿厢以低速点动运行。 When the elevator enters into emergency electric operation, the car travels at low speed inching running.
	五方通话装置 Five way intercom	通过对讲机，可让轿内、轿顶、电梯机房、井道底坑、救援值班室之间通话。 Communication amid car, car top, elevator machine room, well pit and rescue duty room through walkie-talkie.
 节能功能 Energy-saving function	警铃 Alarm bell	紧急时，连续按下轿内操纵箱上的警铃按钮，安装于轿厢顶上的电铃会鸣响。 In emergency conditions, if alarm bell button on car operation panel is continuously pressed, electric bell rings on top of the car.
	消防返回 Fire emergency return	启动位于基站的应急开关，所有召唤均被取消，电梯立即驶往指定救援层站停靠，并自动开门。 If you start emergency switch in main landing, all the callings will be cancelled. The elevator directly and immediately drives to the designated rescue landing and automatically opens the door.
 节能功能 Energy-saving function	轿厢风扇/照明自动开关 Car fan/light on and off automatically	在规定时间内没有召唤或指令信号，轿厢内的风扇和照明会自动关闭，以节能。 If there is no calling or command signal within the stipulated time, the car fan and lighting will be automatically closed in order to save the energy.

# Optional function

## 选配功能

 应急功能 Emergency function	停电应急平层 Emergency landing device	正常电源断电时，充电式电池提供电梯电源，电梯驶往最近层站。 In normal power failure, the chargeable battery supplies the elevator power, The elevator drives to the nearest landing.
	电动松闸 Brake release	无机房电梯，当出现故障时，可以电动松闸，依靠轿厢与对重两侧重量差异，使电梯运行到平层，然后开门放人。 When occur fault in MRL elevator, it can release the brake by using the weight difference of cabin and CWT, to run the elevator to leveling floor and open the door.
	地震功能 Earth quake function	当地震检测装置动作，信号输入到系统，电梯会就近停靠，停止服务，直到地震信号无效，人工复位故障后才恢复正常。 When the signal of earth quake send to system, the elevator will stop and open the door at the nearest floor and stop running. Until earth quake signal is not appear, people reset the fault and the elevator can normally use.
 运行功能 Travel function	群控功能 Group control function	用于三台或三台以上同型号电梯成组控制时使用，电梯选择最合适的应答，避免重复停靠，缩短乘客候梯时间，提高运行效率。 The group control system is used when three or more same model elevators are organized into a group to run, it can make the elevator group automatically choose the most appropriate response, avoid repeated parking, reduce the passengers' waiting time and increase the operation efficiency.
	并联功能 Duplex control	用于两台同型号电梯，通过电脑的调整来统一响应召唤信号，最大限度的减少乘客候梯时间，提高运行效率。 Two sets of same model elevators can unanimously respond the calling signal through the computer dispatch, in this way, it reduces the passengers' waiting time to the greatest extent and enhances the travel efficiency as well.
	能量回馈装置 Energy feedback device	将电梯运行中所产生的能量，通过装置回馈电网，以降低客户的运行成本和环境污染。 Feeding the energy generated during the elevator running and braking back to reduce the customers' operational cost and environmental pollution.

# Optional function

## 选配功能

 运行功能 Travel function	轿厢空气杀菌净化系统 Car Air Sterilization and Purification System	轿厢内置负离子发生器和紫外线灯。 -负离子发生器通过脉冲震荡电路产生负离子和臭氧，实现除尘降尘和杀菌。 -紫外线灯照射杀菌。 实验报告证明PM2.5颗粒净化效率≥95%，杀菌消毒率≥90% The fan is equipped with anion generator and ultraviolet lamp. - The anion generator releases anion and ozone through pulsed oscillation circuit, which removes dust and kills bacteria. - Ultraviolet lamps kill bacteria by irradiation. The experimental report proves that the purification efficiency of PM2.5 particles is ≥95% and the sterilization rate is ≥90%
	轿厢空调系统 Car Air Conditioning System	对轿厢内温度精确设置，微电脑控制，自动恒温，节约用电。 Precise setting of car temperature, microcomputer control, automatic constant temperature, energy efficiency.
	高峰服务 Peak service	在并联或群控运行状态下，为减少乘客等待时间和提高运行效率，电梯在设定的时间段内，响应完所有指令后，立即自动返回高峰服务层 In parallel or group control operation, in order to reduce the waiting time of passengers and improve operation efficiency, the elevator will automatically return to the peak service level immediately after responding to all instructions within the set time period.
	分散待梯 Scattered waiting ladder	在并联或群控运行状态下，当电梯响应完所有指令后，延时一定时间，系统将指派各个电梯自动停靠在设定楼层 In parallel or group control operation state, when the elevator responds to all instructions and delays for a certain time, the system will assign each elevator to automatically stop at the set floor.
 人机界面 Man-machine interface	消防服务 Fire Services	消防员操作模式，没有自动开关门动作，只有通过开关门按钮，点动操作使开关门动作 In the fireman operation mode, there is no automatic door opening and closing action, and only the door opening and closing action can be made by inching the door opening and closing button.
	语音报站 Voice announcer	在正常运行到站的情况下，利用语音装置告知乘客有关信息。 When the elevator normally arrives, voice announcer informs the passengers about the relevant information.
	轿厢副操纵箱 Car assistant operation box	用于大载重量电梯或候梯人群稠密大楼中的电梯，以便让轿厢内更多的乘客方便使用。 It is the large loading weight elevators or the elevators with crowded passengers so that most of the passengers can operate the car easily.
	残疾人操纵箱 Operation box for handicapped people	便于让轿厢内坐轮椅的乘客及视觉障碍的乘客方便使用。 It is convenient for the wheelchair passengers and those who have vision problems.
 监控功能 Monitor function	IC卡、指纹、蓝牙、密码、二维码控制 IC card, fingerprint, Bluetooth, password and QR code control	所有（部分）层站须经授权，方可通过IC卡、指纹、蓝牙、密码、二维码控制输入轿厢指令运行电梯 All (some) landing stations must be authorized before entering the car command to run the elevator through IC card, fingerprint, Bluetooth, password and QR code control
	厅外到站预报灯 Indicator light at landing hall	电梯将要到达该楼层时，该楼层厅外到站预报灯给出将要到站提示。 When the elevator will arrive at this floor, the indicator light will give signal.
	人脸识别 Face recognition	人脸识别乘梯功能 Face recognition elevator function
	电动车检出功能 Electric vehicle detection function	智能检测出电动车禁入轿厢后，发出提示，阻止电梯运行，电动车退出轿厢后自动恢复正常 After intelligently detecting that the electric vehicle is forbidden to enter the car, it will give a prompt to prevent the elevator from running. After the electric vehicle exits the car, it will automatically return to normal
 监控功能 Monitor function	语音呼梯 Voice call ladder	装于轿厢内，可快速响应语音输入并做到精准楼层数据输出 Installed in the lift car, it can quickly respond to voice input and achieve accurate floor data output
	Android手机调试功能 Android phone debugging function	Android手机无线连接一体化控制器，实现参数修改、读写、上传、下载等功能。 The integrated controller of Android mobile phone wireless connection realizes the functions of parameter modification, reading and writing, uploading, downloading and so on.
	厅外到站钟 Arrival bell outside the hall	装于候梯厅的电子钟，告知候梯的乘客电梯已到达本站。 The electronic clock installed in houth hall informs the passengers of the waiting elevator that the elevator has arrived at this station.
	支持多操纵盘及前后门独立控制 Support multiple control panels and independent control of front and rear doors	支持前门主操纵盘、副操纵盘、无障碍操纵盘、无障碍副操纵盘和后门主操纵盘、副操纵盘、无障碍操纵盘、无障碍副操纵盘 Support front door main control panel, auxiliary control panel, barrier free control panel, barrier free auxiliary control panel and rear door main control panel, auxiliary control panel, barrier free control panel and barrier free auxiliary control panel
 监控功能 Monitor function	轿内摄像功能 Camera function in the car	摄像头装于轿厢内监视轿内情况。 The camera is installed in the car to monitor the car condition.
	远程监控功能 Remote monitoring function	通过4G网络与物联网服务器通讯，实现远程监控/调试/维护等功能。 Communicate with the Internet of things server through 4G network to realize remote monitoring / debugging / maintenance and other functions.
	BA接口 Ba interface	BA智能接口 Ba intelligent interface



有齿轮载货电梯土建示意图 (非贯通门)

Freight elevator (single entrance) construction parameters

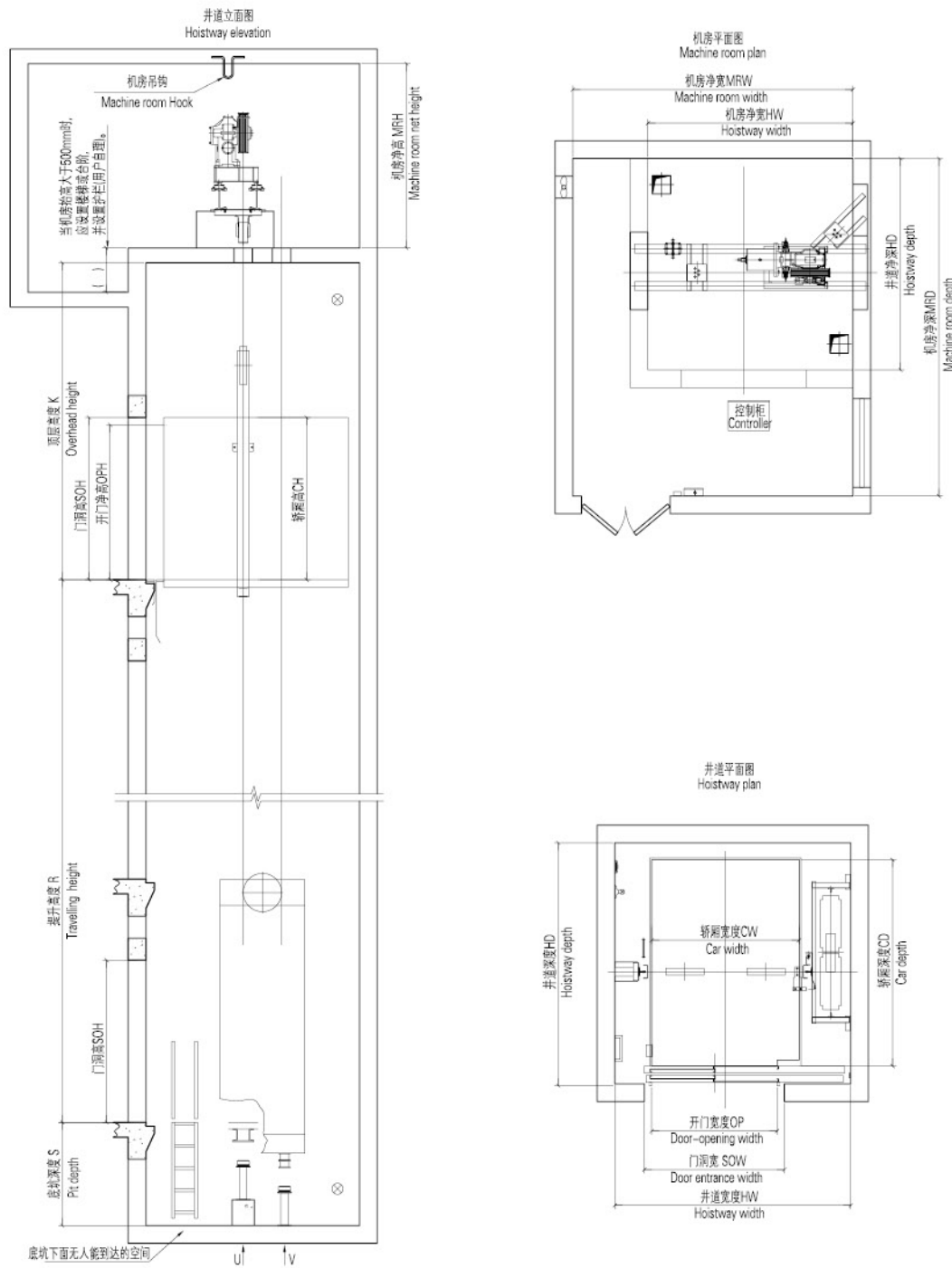

有齿轮载货电梯土建示意图 (贯通门)

Freight elevator (double entrance) construction parameters

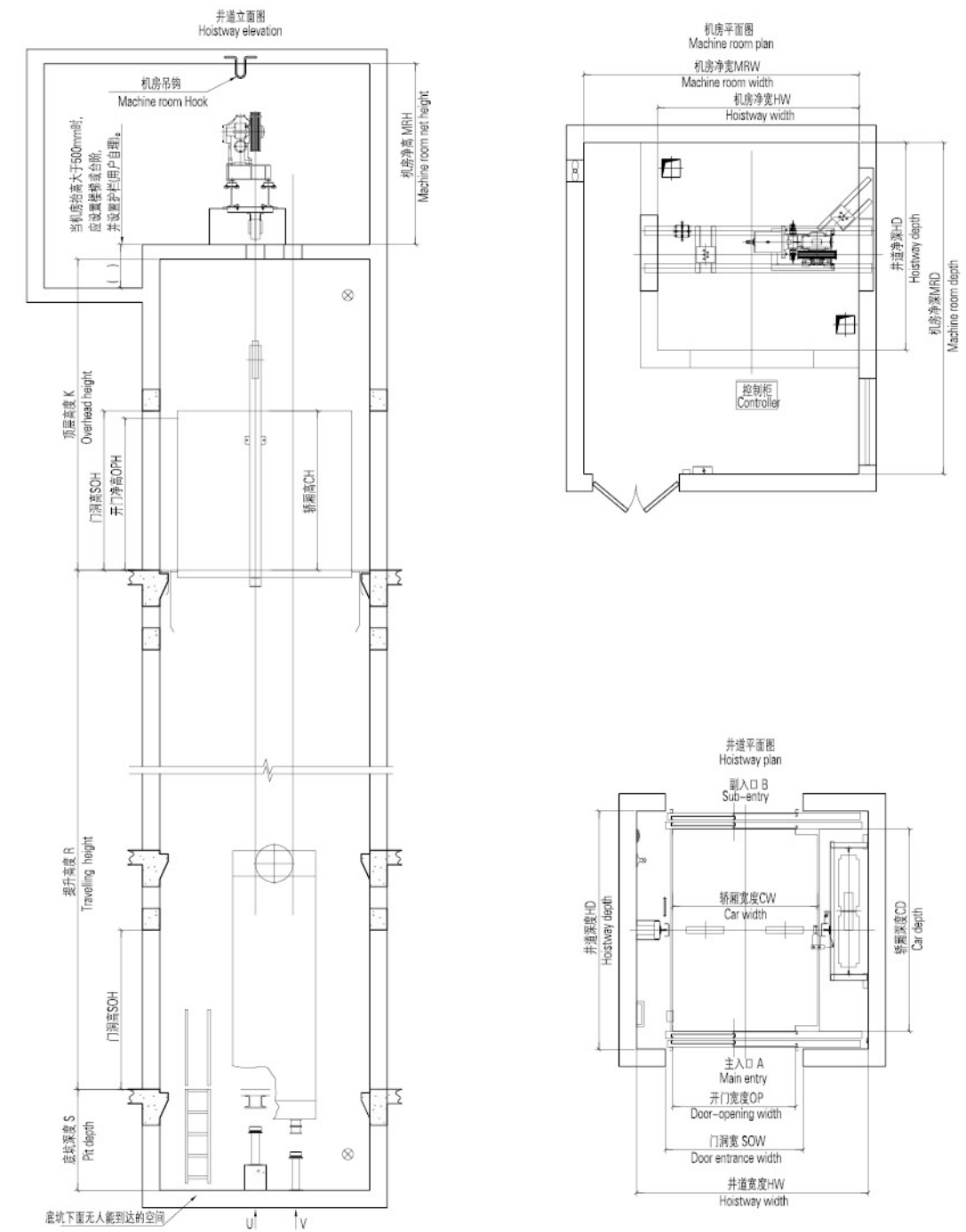

载重量 Kg	速度 m/s	轿厢净尺寸 (mm)					井道净尺寸 (mm)					机房净尺寸 (mm)			提升高度 R 超高, 需要增加 补偿链	当需要增加补偿 链后, 在标 准的顶层+底 坑数值还需要 增加	土建厅门口 预留牛腿
		轿厢 净宽 CW	轿厢 净深 CD	轿厢 净高 CH	开门 净宽 OP	开门 净高 OPH	井道 净宽 HW	井道 净深 HD	门洞宽 SOW	门洞高 SOH	底坑 S	顶层 K	机房 净宽 MRW	机房 净深 MRD			
1000	0.5	1400	1600	2200	1400 (旁开双折)	2100	2500	2070	1600	2200	1400	4300	3300	3700	2500	R ≥ 25米	预留或者 不预留都可以
	1.0	1400	1600		1400 (旁开双折)		1400	4300	3300		3700	2500	R ≥ 25米				
2000	0.5	1700	2400	2200	1500 (旁开双折)	2100	2780	2870	1700	2200	1400	4300	3800	4500	2500	R > 29米	预留或者 不预留都可以
	1.0	1700	2400		1500 (旁开双折)		1400	4300	3800		4500	2500	R > 24米				
3000	0.5	2000	2800	2200	1700 (旁开双折)	2100	3200	3270	1900	2200	1400	4300	4000	5000	2500	R > 18米	预留或者 不预留都可以
	1.0	2000	2800		1700 (旁开双折)		1400	4300	4000		5000	2500	R > 0米				
4000	0.5	2000	3600	2000 (中分双折)	2100	3450	4070	2200	2200	1600	4600	4200	5100	2700	R > 22米	200	标配需要预留 牛腿, 若现场 没预留需要非 标加价处理
5000	0.5	2500	3500	2400 (中分双折)	2300	3900	4000	2400	2400	1600	4700	4400	5100	2700	R > 22米	500	标配需要预留 牛腿, 若现场 没预留需要非 标加价处理

注: 1. 货梯需注意提升高度值, 不同载重速度的标准提升高度不一样, 超过标准提升高度时需考虑补偿链和对重系统, 其中对重系统与顶层底坑有关。  
2. 上述尺寸仅供参考, 具体尺寸以合同签约时提供的土建图为准。 Note: Only for reference, final manufacture please follow contract

载重量 Kg	速度 m/s	轿厢净尺寸 (mm)					井道净尺寸 (mm)					机房净尺寸 (mm)			提升高度 R 超高, 需要增加 补偿链	当需要增加补偿 链后, 在标 准的顶层+底 坑数值还需要 增加	土建厅门口 预留牛腿
		轿厢 净宽 CW	轿厢 净深 CD	轿厢 净高 CH	开门 净宽 OP	开门 净高 OPH	井道 净宽 HW	井道 净深 HD	门洞宽 SOW	门洞高 SOH	底坑 S	顶层 K	机房 净宽 MRW	机房 净深 MRD			
2000	0.5	1700	2400	2200	1500 (旁开双折)	2100	2780	2890	1700	2200	1400	4300	3800	4500	2500	R > 29米	预留或者 不预留都可以
	1.0	1700	2400		1500 (旁开双折)		1400	4300	3800		4500	2500	R > 24米				
3000	0.5	2000	2800	2200	1700 (旁开双折)	2100	3200	3290	1900	2200	1400	4300	4000	5000	2500	R > 18米	预留或者 不预留都可以
	1.0	2000	2800		1700 (旁开双折)		1400	4300	4000		5000	2500	R > 0米				
4000	0.5	2000	3600	2000 (中分双折)	2100	3450	4100	2200	2200	1600	4600	4200	5100	2700	R > 22米	200	标配需要预留 牛腿, 若现场 没预留需要非 标加价处理
5000	0.5	2500	3500	2400 (中分双折)	2300	3900	4000	2400	2400	1600	4700	4400	5100	2700	R > 22米	500	标配需要预留 牛腿, 若现场 没预留需要非 标加价处理

注: 1. 货梯需注意提升高度值, 不同载重速度的标准提升高度不一样, 超过标准提升高度时需考虑补偿链和对重系统, 其中对重系统与顶层底坑有关。  
2. 上述尺寸仅供参考, 具体尺寸以合同签约时提供的土建图为准。 Note: Only for reference, final manufacture please follow contract



无齿轮载货电梯土建示意图 (非贯通门)

Freight elevator (single entrance) construction parameters

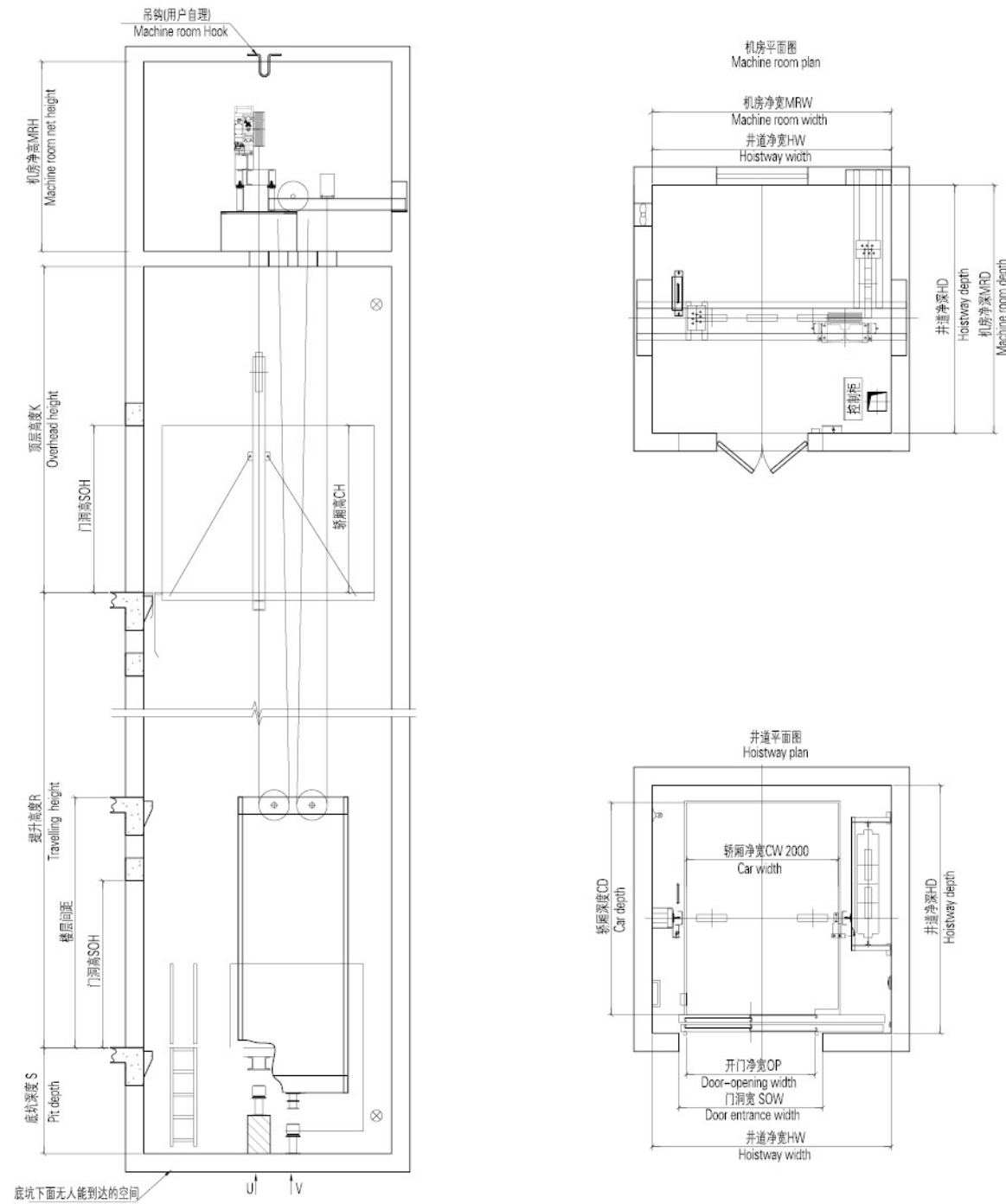

无齿轮载货电梯土建示意图 (贯通门)

Freight elevator (double entrance) construction parameters

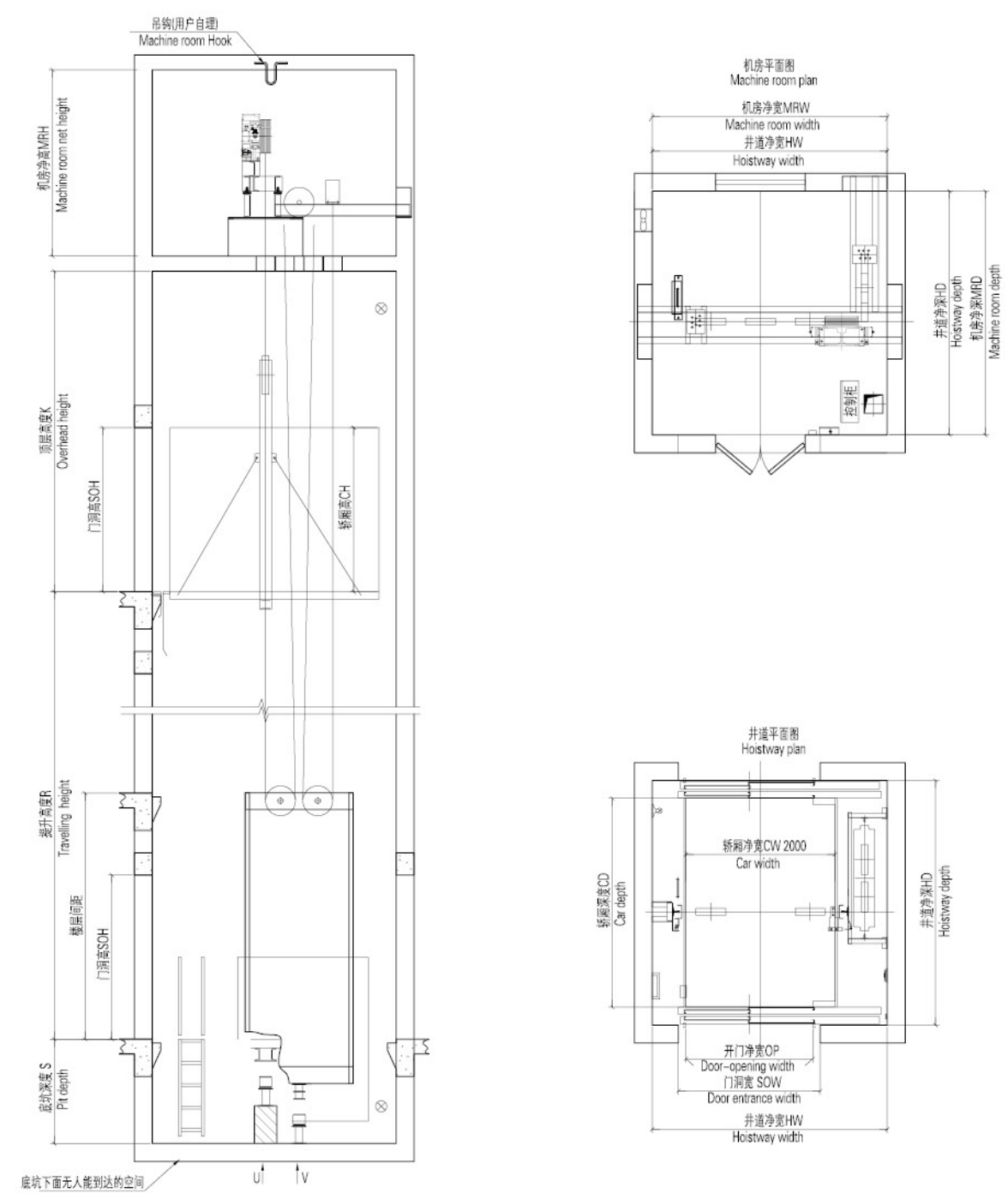

载重量 Kg	速度 m/s	轿厢净尺寸 (mm)					井道净尺寸 (mm)					机房净尺寸 (mm)			提升高度 R 需要增加 补偿链	当需要增加补 偿链后,在标 准的顶层+底 坑数值还需要 增加	土建厅门口 预留牛腿
		轿厢 净宽 CW	轿厢 净深 CD	轿厢 净高 CH	开门 净宽 OP	开门 净高 OPH	井道 净宽 HW	井道 净深 HD	门洞宽 SOW	门洞高 SOH	底坑 S	顶层 K	机房 净宽 MRW	机房 净深 MRD			
2000	0.5	1700	2400	2200	1500 (旁开双折)	2780	2870	1700	2200	1400	4300	2780	2870	2500	R > 20米		
	1.0																
3000	0.5	2000	2800	2200	1700 (旁开双折)	3150	3270	1900	2200	1400	4300	3150	3270	2500	R > 11米		
	1.0																
4000	0.5	2000	3600	2200	2000 (中分双折)	3450	4070	2200	2200	1600	4600	3450	4070	2700	R > 18米	200	标配需要预留 牛腿,若现场 没预留需要非 标加价处理
	1.0																
5000	0.5	2500	3500	2400	2200 (中分双折)	3900	4000	2400	2400	1600	4700	3900	4000	2700	R > 16米	500	
	1.0																

注: 1. 货梯需注意提升高度值, 不同载重速度的标准提升高度不一样, 超过标准提升高度时需考虑补偿链和对重系统, 其中对重系统与顶层底坑有关。  
2. 上述尺寸仅供参考, 具体尺寸以合同签约时提供的土建图为准。 Note: Only for reference, final manufacture please follow contract

载重量 Kg	速度 m/s	轿厢净尺寸 (mm)					井道净尺寸 (mm)					机房净尺寸 (mm)			提升高度 R 需要增加 补偿链	当需要增加补 偿链后,在标 准的顶层+底 坑数值还需要 增加	土建厅门口 预留牛腿
		轿厢 净宽 CW	轿厢 净深 CD	轿厢 净高 CH	开门 净宽 OP	开门 净高 OPH	井道 净宽 HW	井道 净深 HD	门洞宽 SOW	门洞高 SOH	底坑 S	顶层 K	机房 净宽 MRW	机房 净深 MRD			
2000	0.5	1700	2400	2200	1500 (旁开双折)	2780	2890	1700	2200	1400	4300	2780	2870	2500	R > 20米		
	1.0																
3000	0.5	2000	2800	2200	1700 (旁开双折)	3150	3290	1900	2200	1400	4300	3150	3270	2500	R > 11米		
	1.0																
4000	0.5	2000	3600	2200	2000 (中分双折)	3450	4100	2200	2200	1600	4600	3450	4070	2700	R > 18米	200	标配需要预留 牛腿,若现场 没预留需要非 标加价处理
	1.0																
5000	0.5	2500	3500	2400	2200 (中分双折)	3900	4000	2400	2400	1600	4700	3900	4000	2700	R > 16米	500	
	1.0																

注: 1. 货梯需注意提升高度值, 不同载重速度的标准提升高度不一样, 超过标准提升高度时需考虑补偿链和对重系统, 其中对重系统与顶层底坑有关。  
2. 上述尺寸仅供参考, 具体尺寸以合同签约时提供的土建图为准。 Note: Only for reference, final manufacture please follow contract



### 无机房载货电梯土建示意图

Roomless freight elevator construction parameters

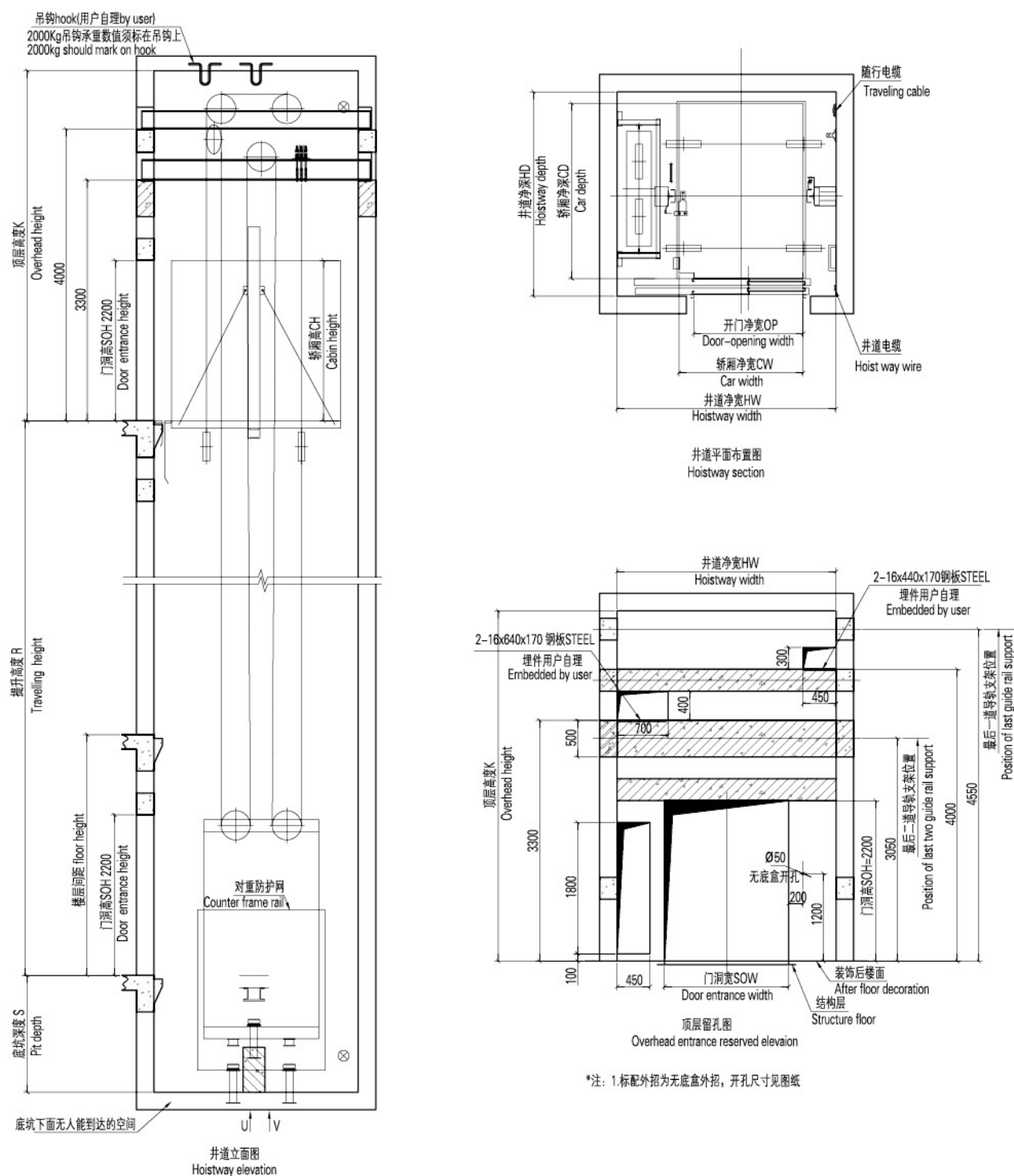

载重量 Kg	速度 m/s	轿厢净尺寸 (mm)					井道净尺寸 (mm)					提升高度 R 超高, 需要增加补偿链	
		轿厢净宽 CW	轿厢净深 CD	轿厢净高 CH	开门净宽 OP	开门净高 OPH	井道净宽 HW	井道净深 HD	门洞宽 SOW	门洞高 SOH	底坑 S		顶层 K
2000	0.5	1700	2400	2200	1500 (旁开双折)	2100	3000	2800	1700	2200	1600	4800	R ≥ 20米
	1.0	1700	2400				3000	2900					1700
3000	0.5	2000	2800		1700 (旁开双折)		3350	3300	1900				R ≥ 11米
	1.0	2000	2800				3350	3300	1900				R ≥ 0米

注: 1. 货梯需注意提升高度值, 不同载重速度的标准提升高度不一样, 超过标准提升高度时需考虑补偿链和对重系统, 其中对重系统与顶层底坑有关。  
2. 上述尺寸仅供参考, 具体尺寸以合同签约时提供的土建图为准。 Note: Only for reference, final manufacture please follow contract

## After-sales service 周全的售后服务

梅轮电梯凭借一流的技术、丰富的管理经验以及优良的服务, 对所提供的产品进行科学的安装、保养和质量监控。选择梅轮电梯, 就是选择了一套完整的服务体系。

公司奉行“以质量为核心、以服务为中心、以客户为中心”的经营理念, 建立了精干的专业安装队伍和全国性的售后服务网络及备品配件供应体系, 为客户提供 24 小时“零距离、全天候”服务。让每一位乘坐梅轮电梯的乘客, 都能拥有轻松愉悦的美好心情!

Meilun elevator with class technology, management experience and excellent service, the products provided by the installation, maintenance and quality control of the science. Select Meilun elevator, is to choose a complete set of service system.

The company pursues "quality, service center, customer-centric" business philosophy, the establishment of a capable professional installation team and a nationwide after-sales service network and spare parts supply system, providing customers with 24 hours "zero distance, the weather service. Let each one take the the Meilun elevator passengers can have a relaxed good mood!

放心

Reassurance

### 良好的品质和不断完善的售后服务

对售出的任何一台电梯都将实施完善的售后服务及终生实行维修保养, 这是我们给您保障, 了却您的后顾之忧。

Rest assured: good quality and perfect after-sales service

It implements the perfect after-sale service and life-long repair & maintenance to every lift which has been sold to the customers. This is our solemn guarantee to you. In this way, you can be rest assured in purchasing our products.

诚心

Sincerity

### 我们的一切服务发自内心, 永续真诚

详细的解释产品的性能特点及使用范围, 尽可能让客户了解梅轮电梯公司产品, 服务及优势。

Heart: all of our services from the heart, and sustainable in good faith

It explains the product properties, features and use ranges in detail in order to let the customers know the products, service and advantages of Meilun company to the greatest extent.

贴心

Intimate

### 只要是客户所想, 我们尽力做到

在交易的过程中, 梅轮公司尽可能的为您想的更多, 且一切都在公平的原则下进行。

Intimate: as long as customers want, we try to do

Meilun company considers more for you as far as possible during the transaction process. With is more, all has been done under the impartial principle.